

Click Vehicle Information to view or add notes:

Name: PIERCE 100FT TOWER  
 Group: USER FIRETRUCKS  
 Type: Pierce 100ft Tower Ladder

Width: 8.00  
 Track: 7.75

Lock to lock time: 8.00 sec  
 Steering lock angle: 38.7 deg

Length: 48.00  
 Unit: feet

TRUCK BODY OUTLINE  
 FRONT WHEEL PATH  
 REAR WHEEL PATH

- LEGEND**
- EXISTING PROPERTY LINE
  - PROPOSED PROPERTY LINE
  - PROPOSED RIGHT OF WAY LINE
  - PROPOSED EDGE OF ROAD WITH CURB
  - PROPOSED ONZED BOXEM GUTTERWALL
  - PROPOSED SIDEWALK
  - PROPOSED MODULAR BLOCK RETAINING WALL
  - PROPOSED FIRE HYDRANT

**NOTES:**

- 1) COMPUTERIZED TRUCK SIMULATION WAS PERFORMED USING 2007 AUTOTURN PROGRAM VERSION 5.1.
- 2) TRUCK USED WAS "PIERCE 100 FT LADDER TOWER", APPROXIMATELY 48 FEET LONG. (SEE SPECIFICATION)
- 3) TRUCK BODY MAY OVERSWING CURBS IN SOME AREAS, IF NO OBSTRUCTIONS EXIST.

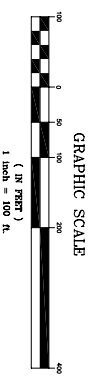

**LANC & TULLY**  
 ENGINEERING AND SURVEYING, P.C.

**CORNWALL COMMONS**

**FIRE DISTRICT PLAN 3 OF 3**

**TOWN OF CORNWALL**  
 ORANGE COUNTY, NEW YORK

APRIL 28, 2008

SCALE: 1" = 100'

DATE: APRIL 28, 2008

PROJECT: FIRE DISTRICT PLAN 3 OF 3

DRAWN BY: [Name]

CHECKED BY: [Name]

DATE: APRIL 28, 2008

COPIES FROM THE ORIGINAL OF THIS DOCUMENT NOT MARKED WITH AN ORIGINAL OF THE PROFESSIONAL ENGINEER'S AND/OR LAND SURVEYOR'S STAMP OR EMBOSSED SEAL SHALL NOT BE CONSIDERED VALID. UNAUTHORIZED ALTERATION OR ADDITION TO THIS DOCUMENT IS PROHIBITED. SECTION 7209-2 OF THE NEW YORK STATE EDUCATION LAW.

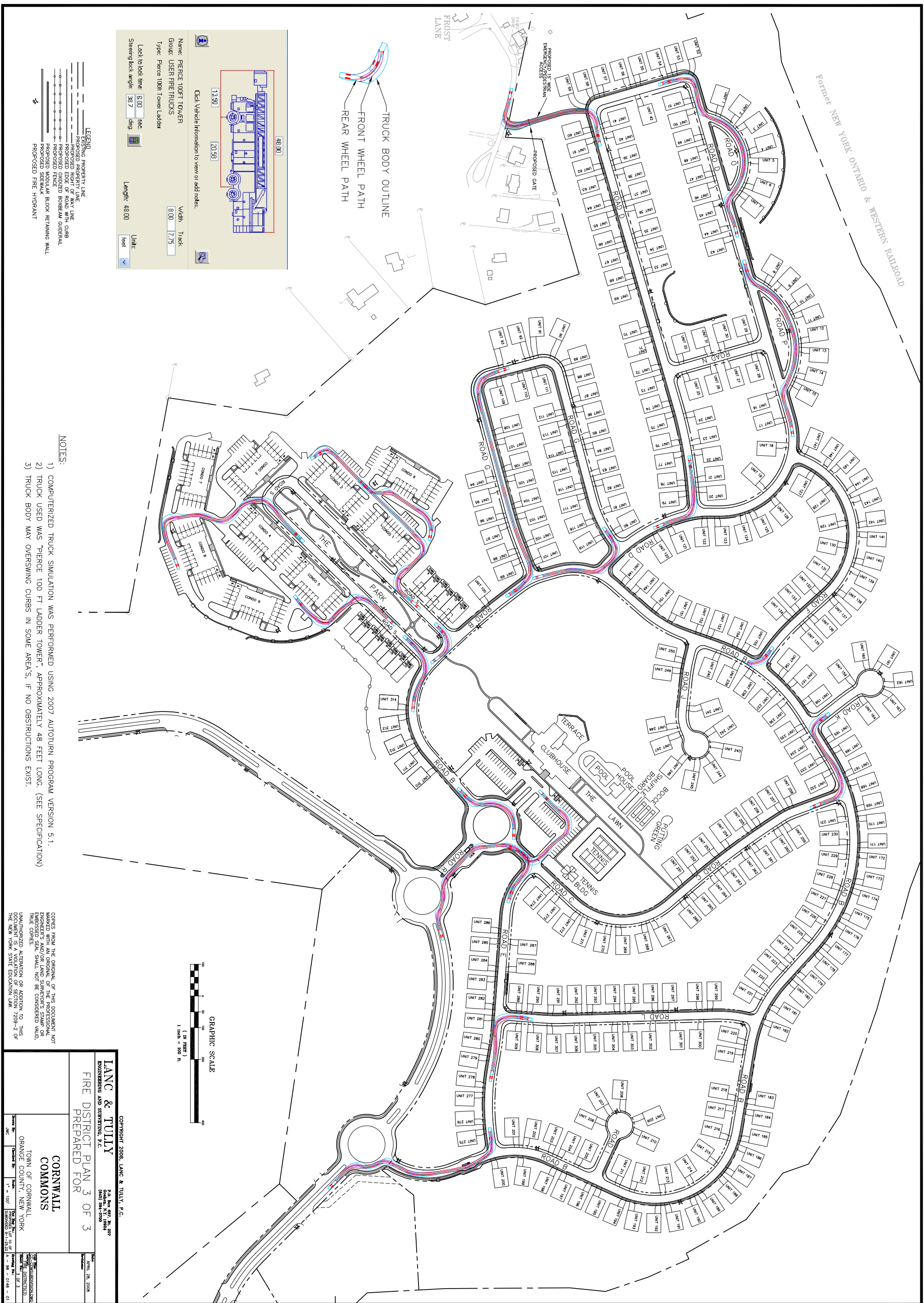

Former NEW YORK ONTARIO & WESTERN RAILROAD